



24th International Conference on

SMiRT

**Structural
Mechanics
in Reactor
Technology**

BEXCO 2nd Exhibition hall, Busan, KOREA, August 20~25 2017



SMiRT-24

24th International Conference on Structural Mechanics in Reactor Technology
August 20~25, 2017, BEXCO, Busan, KOREA
Hosted by KPVP (kpvp@kpvp.org)

[Home](#) [Program](#) [Submission](#) [Registration](#) [Sponsorship/Exhibitions](#) [Accommodation](#) [Venue](#)



Participation in SMiRT-24

On behalf of the SMiRT-24 Conference (2017) Organizing Committee, we are pleased to invite you to participate in the program for SMiRT-24!

Participation in SMiRT-24 is open to all individuals or organizations interested in applying technology to structural mechanics goals and to non-technical individuals and organizations interested in learning about the application of technology to structural mechanics in reactor technology

Topic

Following the conference topics include but are not limited to :

1. Mechanics of Materials
2. Fracture Mechanics and Structural Integrity
3. Applied Computation, Simulation and Animation
4. Characterization of Loads
5. Modelling, Testing and Response Analysis of Structures, Systems and Components
6. Design and Construction issues
7. Safety, Reliability, Risk and Margins

CONTENTS

- 1. Hello from Prof. Chang**
- 2. Co-operating organizations**
- 3. SMiRT-24 venue and dates**
- 4. Conference organization**
- 5. Timeline**
- 6. Budget**
- 7. Pre and post conference seminars and technical visit**
- 8. Social program & Technical program**
- 9. Conference facilities**

ANNEX

- a. Letters of support**
- b. Summary of local steering committee**
- c. Bexco & Busan**

Hello from Prof. Chang

Dear IASMiRT president Dave Shepherd and Friends:

First of all, I would like to congratulate SMiRT-23 conference to be held in Manchester, England, and say Hallo to all my friends with apology for my weak contribution to IABMiRT after my retirement from Seoul National University in 2008.

Just a few years ago, many policy makers worldwide had considered nuclear power as a sustainable energy source which reduces carbon emissions while increasing energy security. However, after the Fukushima nuclear disaster we are facing the issue about the stability of global energy system. Related to this, the nuclear power debate between proponents and opponents seems to be tensed up than ever before standing at a cross road of high risk and high return. I expect that the efforts of SMiRT-23 conference can reduce the gap between the two extremities and revitalize the nuclear industry.

Also, I am very pleased to hear that the venue for SMiRT-24 conference has been determined as Korea. Looking back the moment we hosted SMiRT-15 conference that was held in Korea in 1999, I am deeply moved once more.

I strongly desire that the success of SMiRT-23 will be continued to SMiRT-24 conference in Korea in 2017. Prof. Goon Cherl Park who is in charge of nuclear industry of Korea has started preparing for SMiRT-24 conference while conceiving the economic revival of nuclear industry. With the same spirit, I will support him through everything I could. Once again, I sincerely hope that SMiRT-23 conference will be highly successful.

With my best regards,
Emeritus Sung Pil Chang
Seoul National University
Chair of SMiRT-15 Seoul Conference





Co-operating organizations

Co-operating organizations

➤ Co-operating organizations at the current status (Jul. 31) are :



Korean Nuclear Society (KNS)



Korean Society of Pressure Vessels and Pipings (KPVP)



KEPCO E&C



Doosan Heavy Industries & Construction



Korea Atomic Energy Research Institute

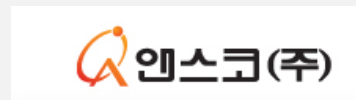

ANSCO



UMI



Kyung Hee University



Chosun University



Yeungnam University



Venue and dates

BEXCO (Busan Exhibition & Convention Center)

- Landmark of famous port city of Busan
- The largest exhibition hall in Korea with a size of 26,400m²
- It offers large scale conference facilities, spacious exhibition halls and other multi-purpose halls.
- The center has been the main venue for a variety of international events including 2005 APEC Summit, 2004 ITU Asia and 2002 FIFA World Cup Final Draw Ceremony.

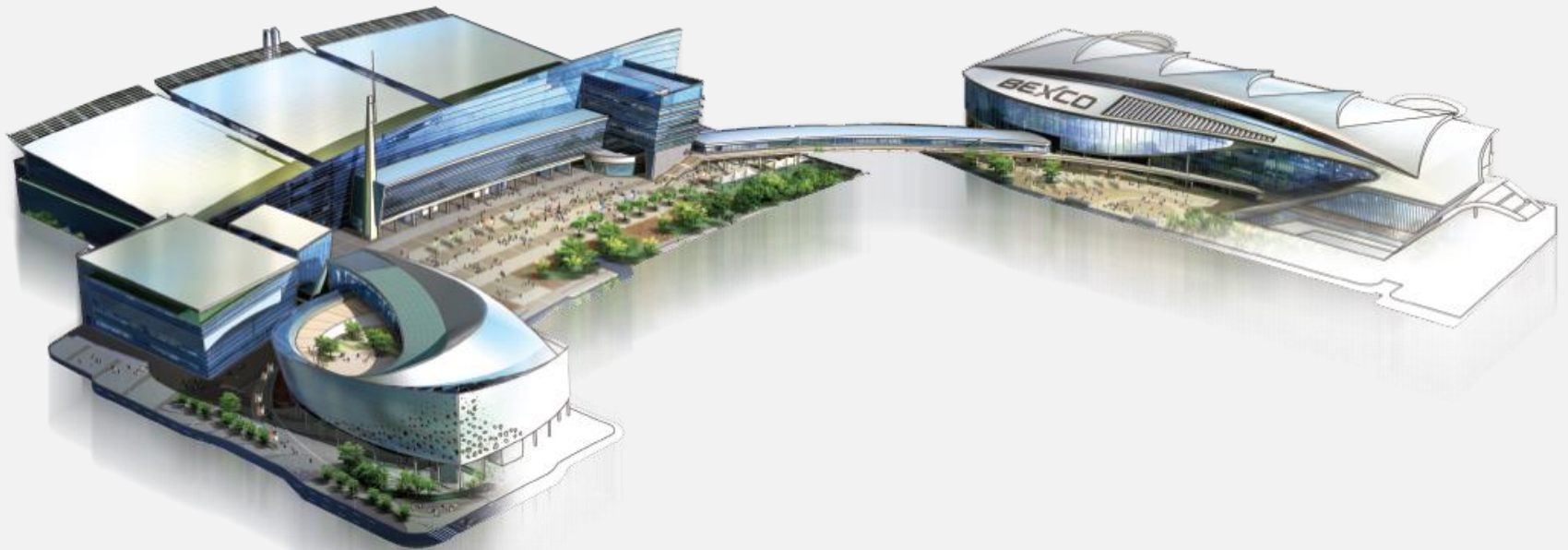

BUSAN

- As the World's 5th Busiest Port, Busan is Korea's Maritime Capital
- Asia 5th, World 13th convention destination in 2014 by UIA*
 - * **Union of International Association**
- It usually takes around 3 hours from Seoul to Busan by KTX high-speed train.
- Busan, so-called 'summer capital', is the no.1 spot for summer vacation in Korea.

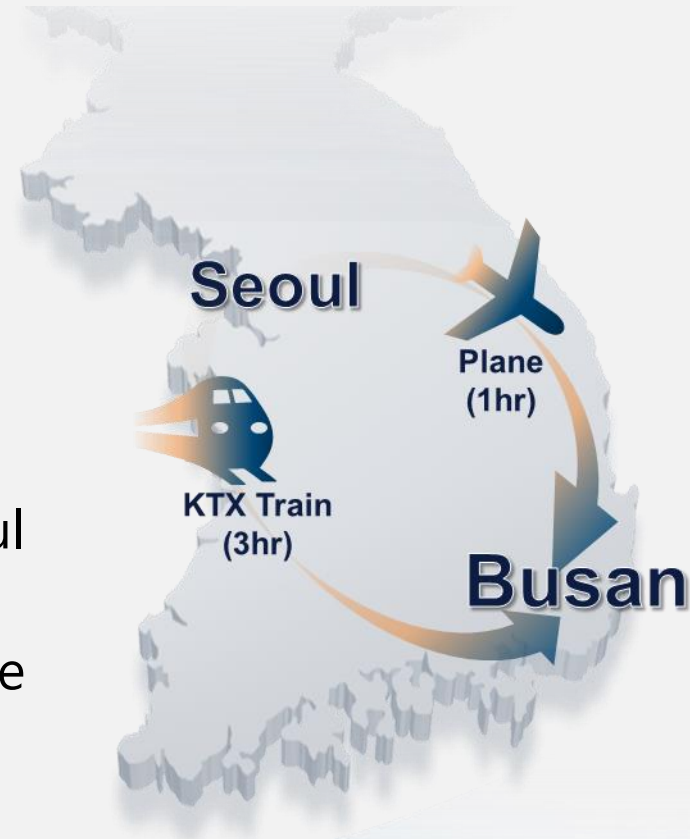

Date of SMiRT-24

- SMiRT conference has traditionally been held in August, the best time to visit Busan in terms of weather and availability of infrastructure.
- And SMiRT24 is planned from

August 20 to 25, 2017

(August 25, Technical Tour)

- Conference participants would not have any problem in reserving accommodations or visiting tourist attractions because the conference is slated to be held after high season.

Conference organization

4



Conference organizations

- The conference will be organised under the guidance of a local steering committee composed of the representatives from KEPCO ENC, KHNP, KPVP, and Korea University.

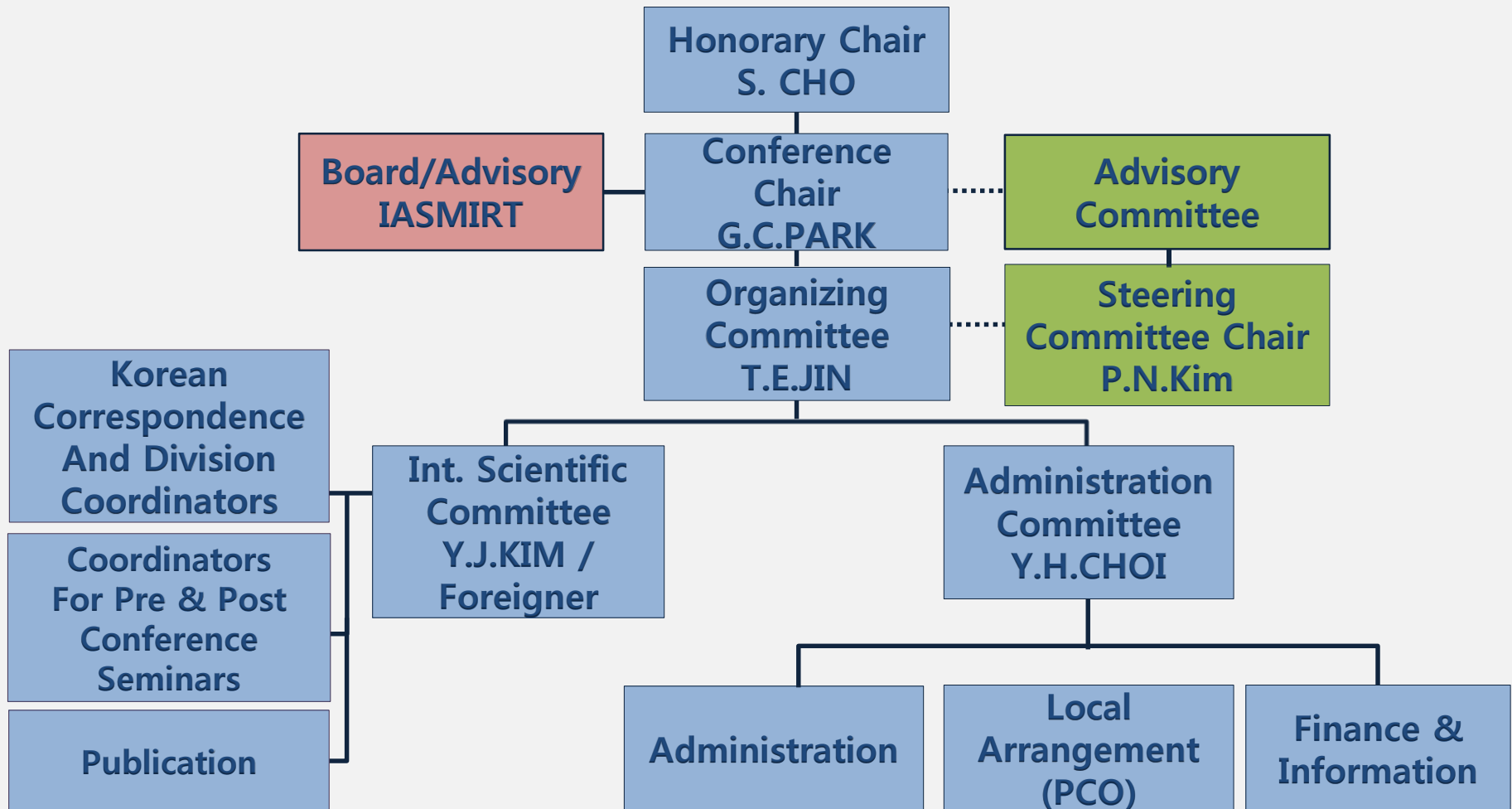

Timeline

5



Timeline

Date	Tasks
August 2015	Board meeting in Manchester
August 2015	Planning meeting in Manchester
December 2015	Fix organization and supporters
January 2016	Board Meeting in Busan (26~28, Paradise Hotel)
March 2016	Second announcement, Collection of abstracts
September 2016	Deadline for abstracts
November 2016	Planning, Board and ISC Meeting
April 2017	Deadline for papers, third announcement, and registration
June 2017	Early registration
August 2017	SMiRT 24

An aerial photograph of a bustling outdoor market. The ground is covered with numerous colorful umbrellas in various patterns, including stripes and solid colors. People are seen walking through the market, and various goods are displayed on the ground. The scene is vibrant and busy.

Budget



Budget

Unit \$ 1000

Income		Expenditure	
Paid delegates-150 assumed at \$1200	180	Venue	100
Early bird delegates-300 assumed at \$ 1000	300	AV equipment	100
Student delegates-50 assumed at \$500	25	Catering	100
Sponsorship	120	Conference dinner	60
Exhibition booths	120	Printing and advertising	100
		SMiRT website	15
		Simultaneous interpretation	20
		January 2016 Board meeting	20
		November 2016 Planning meeting	20
		SMiRT dues	20
		Miscellaneous office and conference expenses(CDs, delegates packs etc)	70
		Management-conference planning and administration	70
		Contingency	50
Total	745	Total	745

*Based on the assumption of 500 delegates

A night view of a city skyline with a bridge and fireworks exploding in the sky. The fireworks are in various colors including red, green, yellow, and white. The city lights are visible in the background, and the bridge is illuminated. The water in the foreground is dark with some reflections.

**Pre and post
conference seminars
and technical visit**

7

Pre and post conference seminars and technical visit

- Pre and post conference seminars will be invited on a self-funding basis. Topics most likely to be discussed during the seminars include Remedy Action for Fukushima Accident and Safety Cultures of Nuclear Power Plants. The pre and post conference seminars will be held in Busan. (and Jeju Island)



- Busan is within reasonable travelling distance from Kori and the Shin-Kori sites. It is also 1 1/2 hour's drive from Busan to the radioactive waste disposal facility in Kyungju. The organization is arranging a technical visit to one of these sites.



Social program Technical program

8

Social program

- Along with arrival receptions and conference dinner, visits to Beomeosa Temple or Busan city tour will be arranged as part of the social program.
- Social committee will be available to provide other travel advice and recommendations for anyone who wants to visit tourist attractions near Busan. In particular, a tourism information booth will be run during the conference period for providing more detailed information about your travel.
- As described in Annex 3, Busan has excellent tourist attractions for delegates and their families. Kyungju city, a repository of historic treasures, is within reasonable driving distance from Busan. Conference participants can also visit Jeju Island by taking either plane or ferry after the conference. Jeju Island is the most iconic travel destination during the summer holiday season in Korea.

Technical program

- Doosan Heavy Industry : Confirmed



- Others (Shin Kori sites etc.)



Conference facilities

Conference facilities

- The local committee will provide first class venue for the conference at a convenient and vibrant location. More details of BEXCO are provided in annex 3.
- Busan offers a large variety of hotels and amenities that cater to the different needs and taste of conference participants. Delegates can choose from a wide range of accommodations, from luxury five-star hotels to budget rooms. Increasing number of visitors are staying in serviced apartments. The city provides the best selection of hotels near Haeundae beach. Haeundae features a wide range of leisure facilities and breathtaking ocean views. Visitors can easily get to Haeundae by inter-city bus or subway(Refer to Annex 3). Delegates can reserve a block of hotel rooms via our hotel booking agents.

Conference facilities

- If participants want to stay right next to Busan BEXCO, our booking agent will recommend best accommodation options. Since a wide range of hotels are available in Busan, delegates can stay in a hotel located just across the street from the conference venue or away from downtown.
- If delegates want to stay away from the central part of Busan city, they can have a broader array of choices for accommodation such as rural retreat. They are able to have easy access to downtown and tourist sites by using public transportation.



Accommodations

53,238 rooms all across Busan
17 hotels with over 4,000 rooms in
10 minute Zone

Price \$60~\$300

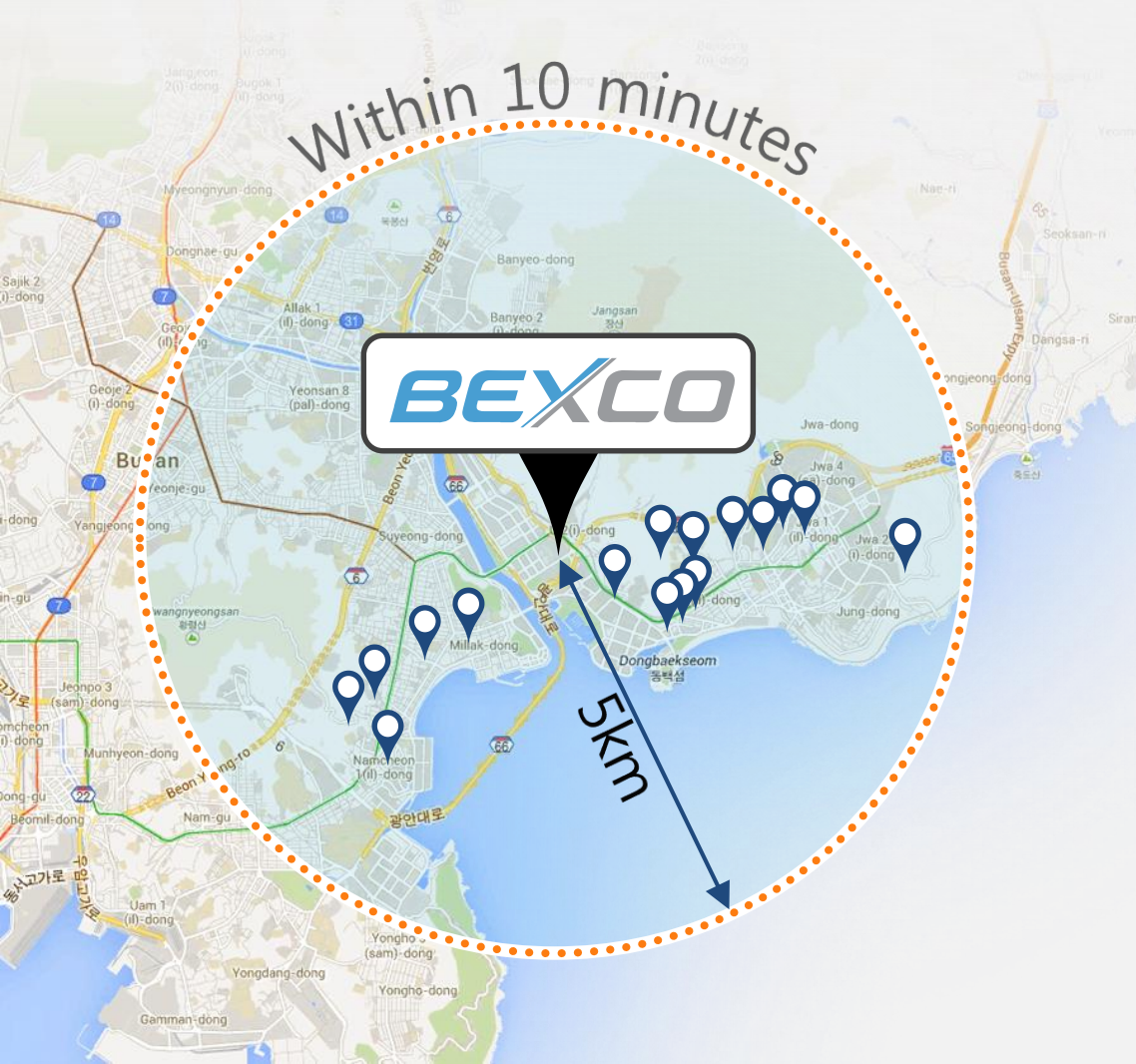

Westin Chosun



Paradise



Novotel Ambassador



Heaundea Grand



Aqua Palace



Homers



Heaundea Centum



Seacloud



Illua



Toyoko Inn



Riviera



Hanwha Resort

List of Major Accommodations

Accommodations within **10 minutes walking distance**

※ Currency = USD

No.	Classification	Name of Hotel	No. of rooms	Room Rate	Remarks
Total			5,434		
1	Super deluxe	Novotel Ambassador	327	170	1. Rates are subject to 10% service charge and 10% V.A.T 2. Breakfast excluded. 3. Rates will be changed , according to the rate of inflation
2		Paradise Hotel Busan	538	250	
3		Haeundae Grand Hotel	320	150	
4		Westin Chosun Beach	290	220	
5		Haeundae Resort	400	Open in 2016	
6		Sega Group Hotel	770	Open in 2017	
7		Park Hayatt Busan	269	350	
8	Deluxe	Homers Hotel	106	80	
9		Haeundae Centum Hotel	543	150	
10	Business	Seacloud Hotel	416	125	
11		Rivera	91	60	
12		Toyoko Inn	200	80	
13	Residence	Glory Condominium	244	60	
14		Hanwha Resort	417	99	
15	Youth hostel	Arpina Youth Hostel	103	99	

Summary of Progress for SMiRT-24

➤ Done

- Formed the Local Organizing & Steering Committee
- Contracted with BEXCO for SMiRT-24
- Received Signed Letters of Support from Sponsors (on-going)
- Opened preliminary Homepage (www.smirt24.org)
- Confirmed the Technical Tour
- Distributed CFP during ICAPP 2015, PVP 2015, SMiRT 23
- Fixed Follow-up Meeting Schedule
 - . Board Meeting : Jan. 28~29, 2016 (Paradise Hotel, Busan)
 - . Board & Advisory & ISC : November, 2016 (Seoul or Busan)

➤ To be done

- Determine the Location for Conference Reception
- Finalize and Reserve the Hotels & Social Programs
- Compose of ISC
- Planning of Follow-up Meetings (Jan. & Nov. 2016)
- Others



Annex 1.

Letter of support

2

2354, Yonggudaero, Giheung-gu, Yongin-si, Gyeonggi-do, 446-713 Korea
TEL: +82 (0)31 8021 6400 / FAX: +82 (0)31 8021 6438

June 30, 2015

Dr. Farhang Ostadan
President of IASMiRT
Bechtel Corporation USA

Subject: Proposal to host 24th SMiRT Conference in Busan, Korea in 2017

Dear President Ostadan and Members of the IASMiRT Board;



KEPCO ENC, in association with the Korean Society of Pressure Vessel and Piping (KPVP), is pleased to submit the proposal to host the 24th International Conference on Structural Mechanics in Reactor Technology (SMiRT 24) in 2017 in Busan, Korea. KEPCO ENC has agreed to support this event as part of its Technical Excellence program. KEPCO ENC is one of the leading engineering and construction firms for nuclear power plants and has been designing several new plants in the last few years. KEPCO ENC, the former KOPEC, successfully conducted SMiRT 15 in Seoul, Korea in 1999.

In preparation of this proposal we have worked closely with KPVP members. They will attend the Board meetings on this August 2015, in Manchester and have agreed to respond to any question you may have.

We appreciate your consideration of our proposal and look forward to collaborating with the Board Members in executing SMiRT 24 during these times of the resurgence of nuclear power construction worldwide.

Should you have any question on this subject, please do not hesitate to contact us.

Sincerely yours.

Koo Woun Park
President & CEO
KEPCO ENC

Goon-Cherl Park
Professor
Seoul Nat'l University
Chairman SMiRT 24



Bum Nyun Kim
President of KPVP
KHNP

2354, Yonggudaero, Giheung-gu, Yongin-si, Gyeonggi-do, 446-713 Korea
TEL: +82 (0)31 8021 6400 / FAX: +82 (0)31 8021 6438

30th June, 2015

PARK, Goon-Cherl

Chairman of SMiRT-24
Professor of Seoul National University

Subject : Letter of Support

Dear Professor Park,

KEPCO E&C, as the leading engineering company supporting generation capacity in Korea, is proud to support your bid to host the 24th Structural Mechanics in Reactor Technology (SMiRT 24) conference in 2017 in Korea.

This prestigious international conference has supported both safety and integrity improvement of the nuclear technology since the early seventies, which have helped both safety and plant operations worldwide. Noting the recent positive developments in relation to new nuclear build in Korea, for which KEPCO E&C is taking a leading role, I feel that it is particularly relevant at this time to support your bid to host SMiRT 24.

In anticipation that the International Association of SMiRT will also support your bid to host SMiRT 24 in Korea, please note that KEPCO E&C, in collaboration with other organization and the local organizing committee are happy to underwrite the financial solvency of the conference and, as such are committed to ensure the successful outcome of the conference itself.

I trust this letter of support will be sufficient to help secure the Korea bid to host the SMiRT 24 in 2017.

Best Regards,

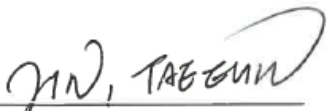

Tae Eun JIN
Senior Vice President
Power Engineering Research Institute
KEPCO E&C



두산중공업

서울사무소
137-920 서울시 서초구 서초동 1303-22
T 02 513 6114
F 02 513 6200

PARK, Goon-Cherl
Chairman of SMiRT-24
Professor of Seoul National University

Subject : Letter of Support

Dear Professor Park,

Doosan Heavy Industries and Construction Co., LTD., as the leading engineering company supporting generation capacity in Korea, is proud to support your activities in hosting the 24th Structural Mechanics in Reactor Technology (SMiRT 24) conference in 2017 in Korea.

This prestigious international conference has supported both safety and integrity improvement of the nuclear technology since the early seventies, which have helped both safety and plant operations worldwide. Noting the recent positive developments in relation to new nuclear build in Korea, for which Doosan Heavy Industries and Construction Co., LTD. is taking a leading role, I feel that it is particularly relevant at this time to support your activities in hosting SMiRT 24.

In anticipation that the International Association of SMiRT will also support your activity to host SMiRT 24 in Korea, please note that Doosan Heavy Industries and Construction Co., LTD., in collaboration with other organizations and the local organizing committee are happy to underwrite the financial solvency of the conference and, as such are committed to ensure the successful outcome of the conference itself.

I trust this letter of support will be sufficient to help secure the **Korea to host the SMiRT 24 in 2017.**

Best Regards,



Kim, Ha-Bang
Executive Vice President of
Doosan Heavy Industries and Construction Co., LTD.

PARK, Goon-Cherl
Chairman of SMiRT-24
Professor of Seoul National University

Subject : Letter of Support

Dear Professor Park,

Korean Society of Pressure Vessels and Piping (KPVP) as the leading engineering company supporting generation capacity in Korea, is proud to support your activities in hosting the 24th Structural Mechanics in Reactor Technology (SMiRT 24) conference in 2017 in Korea.

This prestigious international conference has supported both safety and integrity improvement of the nuclear technology since the early seventies, which have helped both safety and plant operations worldwide. Noting the recent positive developments in relation to new nuclear build in Korea, for which Korean Society of Pressure Vessels and Piping (KPVP) is taking a leading role, I feel that it is particularly relevant at this time to support your activities in hosting SMiRT 24.

In anticipation that the International Association of SMiRT will also support your activity to host SMiRT 24 in Korea, please note that Korean Society of Pressure Vessels and Piping (KPVP), in collaboration with other organizations and the local organizing committee are happy to underwrite the financial solvency of the conference and, as such are committed to ensure the successful outcome of the conference itself.

I trust this letter of support will be sufficient to help secure the Korea to host the SMiRT 24 in 2017.

Best Regards,

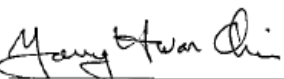

Young Hwan Choi
Vise President of KPVP

PARK, Goon-Cherl
Chairman of SMiRT-24
Professor of Seoul National University

Subject : Letter of Support

Dear Professor Park,

Korean Nuclear Society, as the leading engineering company supporting generation capacity in Korea, is proud to support your activities in hosting the 24th Structural Mechanics in Reactor Technology (SMiRT 24) conference in 2017 in Korea.

This prestigious international conference has supported both safety and integrity improvement of the nuclear technology since the early seventies, which have helped both safety and plant operations worldwide. Noting the recent positive developments in relation to new nuclear build in Korea, for which Korean Nuclear Society is taking a leading role, I feel that it is particularly relevant at this time to support your activities in hosting SMiRT 24.

In anticipation that the International Association of SMiRT will also support your activity to host SMiRT 24 in Korea, please note that Korean Nuclear Society, in collaboration with other organizations and the local organizing committee are happy to underwrite the financial solvency of the conference and, as such are committed to ensure the successful outcome of the conference itself.

I trust this letter of support will be sufficient to help secure the Korea to host the SMiRT 24 in 2017.

Best Regards,



Hyun Jung MIN
Chief Manager
Korean Nuclear Society

PARK, Goon-Cherl
Chairman of SMiRT-24
Professor of Seoul National University

Subject : Letter of Support

Dear Professor Park,

UMI, as the leading engineering company supporting generation capacity in Korea, is proud to support your activities in hosting the 24th Structural Mechanics in Reactor Technology (SMiRT 24) conference in 2017 in Korea.

This prestigious international conference has supported both safety and integrity improvement of the nuclear technology since the early seventies, which have helped both safety and plant operations worldwide. Noting the recent positive developments in relation to new nuclear build in Korea, for which UMI is taking a leading role, I feel that it is particularly relevant at this time to support your activities in hosting SMiRT 24.

In anticipation that the International Association of SMiRT will also support your activity to host SMiRT 24 in Korea, please note that UMI, in collaboration with other organizations and the local organizing committee are happy to underwrite the financial solvency of the conference and, as such are committed to ensure the successful outcome of the conference itself.

I trust this letter of support will be sufficient to help secure the **Korea to host the SMiRT 24 in 2017.**

Best Regards,

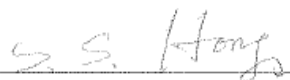

HONG, Soon-Shin

Vice President

UMI

첨부 2. 영문 후원 서신(Sample)

------(기관 헤딩)-----

PARK, Goon-Cherl
Chairman of SMiRT-24
Professor of Seoul National University

Subject : Letter of Support

Dear Professor Park,

(Name of Company), as the leading engineering company supporting generation capacity in Korea, is proud to support your activities in hosting the 24th Structural Mechanics in Reactor Technology (SMiRT 24) conference in 2017 in Korea.

This prestigious international conference has supported both safety and integrity improvement of the nuclear technology since the early seventies, which have helped both safety and plant operations worldwide. Noting the recent positive developments in relation to new nuclear build in Korea, for which **(Name of Company)** is taking a leading role, I feel that it is particularly relevant at this time to support your activities in hosting SMiRT 24.

In anticipation that the International Association of SMiRT will also support your activity to host SMiRT 24 in Korea, please note that **(Name of Company)**, in collaboration with other organizations and the local organizing committee are happy to underwrite the financial solvency of the conference and, as such are committed to ensure the successful outcome of the conference itself.

I trust this letter of support will be sufficient to help secure the **Korea to host the SMiRT 24 in 2017.**

Best Regards,



김명식 * Kim Myung Sik
Administration Div. Director
ANSCO.

Supporting Organizations for SMiRT 24

➤ Date of Jul. 31 :



Korean Nuclear Society (KNS)



Korean Society of Pressure Vessels and Pipings (KPVP)



KEPCO E&C



Doosan Heavy Industries & Construction



Korea Atomic Energy Research Institute

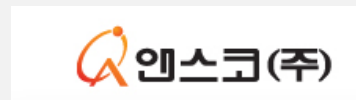

ANSCO



UMI



Kyung Hee University



Chosun University



Yeungnam University



Annex 2

Summary of Local steering committee



Brief Summary of Local committee

- Prof. Goon-Cherl PARK , Former President of KINGS Univ.

Prof. PARK is the Former President of KEPCO International Nuclear Graduate School(KINGS) University. Now he return to Seoul National University. He received his Ph.D. degree at the Rensselaer Polytechnic Institute in 1983 and his Master's (1979) and Bachelor's (1975) degrees in Nuclear Engineering from the Seoul National University. His research topics include the thermal-hydraulic design, safety analysis and development of next generation reactors such as VHTGR for hydrogen generation. He had many careers such as, President of Korean Nuclear Society, Commissioner of Nuclear Safety Commission, Commissioner of Nuclear Energy Commission, a member of Board of Directors in Korea Hydro and Nuclear Power Co. (KHNP), and recently, Chairman of Board of Directors in Korea Institute of Non-proliferation and Control. (KINAC).

- Tae Eun JIN, Senior Vice President, KEPCO ENC
- Yun Jae KIM, Professor, Korea Univ.
- Young Hwan CHOI, Senior Vice President, KINS



Annex 3.

Bexco & Busan

BEXCO(Busan Exhibition & Convention center)

An ideal venue for holding international conferences, seminars and exhibitions

- ✓ Large international exhibition/convention center with eight floors (1BF~7F, 92,761 m²)
- ✓ Spacious exhibition halls (as large as three football fields combined)
- ✓ multi-purpose halls
- ✓ outdoor exhibition halls
- ✓ Equipped with advanced equipment



BEXCO

Busan Head Office

#55 APEC-ro, Haeundae-gu, Busan (Postal Code 612-704)

TEL. 82+51-740-7300 FAX. 82+51-740-7320 E-mail.

bexco@bexco.co.kr

Seoul Office

#1905 Trade Tower 159-1 Samseong-dong, Gangnam-gu,
Seoul (Postal Code 135-729)

TEL. 82+2-6000-6644 FAX. 82+2-6000-6647

Conference Facilities in BEXCO

- **Multi-functional Hall**
2nd & 3rd floors : 15 seminar rooms with natural lighting
- **Convention Hall**
1st& 2nd floors : 21 conference rooms
3rd floor : main conference hall with 2,400 seats
- **Multiple Conference Features :**
theater, classrooms and reception
- **Presentation Equipment :**
air conditioners, international video conference systems, OS screens, high technology A/V systems with simultaneous interpretation system in 8 languages.



Exhibition Facilities in BEXCO

- **Existing Exhibition Hall**(26,508m²)
 - single-story pillar-free exhibition hall which can be divided into 5 separate spaces.
- **New Exhibition Hall**(20,000m²)
 - two-story hall which can be divided into maximum of 11 halls.
- **Auxiliary Facilities**
 - Glass Hall: Mostly used as a lobby for registration desk and coffee breaks
 - Multi-functional Space-offices: Generally used for seminar rooms, mid/small- sized exhibition halls, and restaurants
 - Outdoor Exhibition(13,223m²) : suitable for large-scale exhibitions, outdoor concerts, and other kinds of events

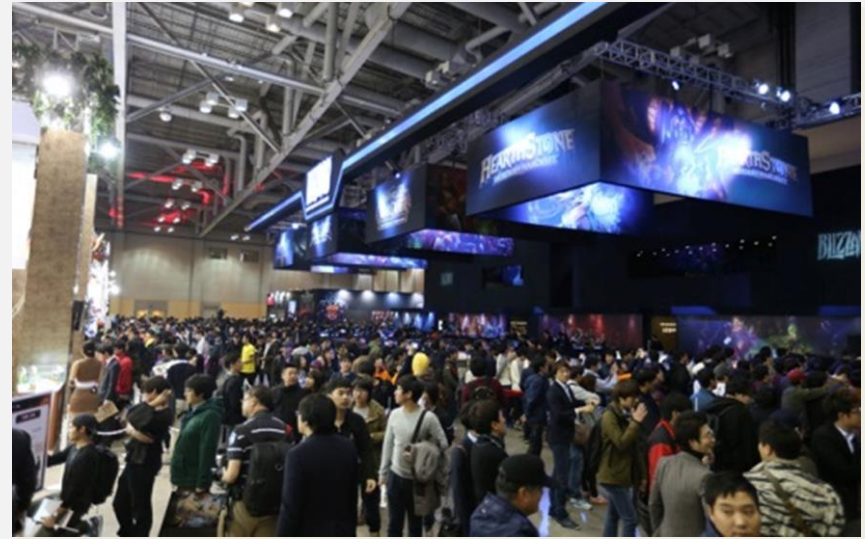

BUSAN

- **Busan, South Korea's second largest metropolis** after Seoul, with a population of approximately 3.6 million.
- located on the southeastern-most tip of the Korean peninsula
- Its geography includes **a coastline with superb beaches and scenic cliffs, mountains** which provide excellent hiking and extraordinary views, and hot springs scattered throughout the city.
- Busan enjoys four distinct seasons and a temperate climate that never gets too hot or too cold.



BUSAN city

- The Busan metropolitan area is divided into 15 major administrative districts and a single county.
- Busan serves as the economic and logistics hub of Korea's Southeast Economic Belt where Korea's leading industries are located. A total of 90% of national output in shipbuilding, 90% of ship parts, 45% of automobile, and 40% of machinery is produced in the region.



How to get to BUSAN ?



- **KTX high-speed train** to travel from Seoul to Busan is cheaper than taking plane. The train operates from Seoul Station to Busan Station. It also stops at Daejeon and Daegu. Time travel from Seoul to Busan takes **about 3.5 hrs.** You should reserve seats in advance since trains are often full, especially on Sundays. There is a special desk where foreigners can buy tickets, and avoid the long queues, to the right of the main ticket counter. You can also book online via www.korail.com.



- **Flights from Seoul to Busan** are cheap and convenient. There are some 20-30 flights each day between Seoul's Kimpo Airport and Busan's Kimhae Airport. The flight only takes **an hour** and costs around 100,000 Won, even for a last minute flight. City buses and limousine buses also run from the airport to downtown and BEXCO area.

Metro

- The subway is the most convenient mode of transport to travel around Busan.
- It operates from 5:30am-1am.
- 5 subway lines are operating around the city.
- You won't get lost since the stations are labeled in Korean, English and Chinese and numbered as well.

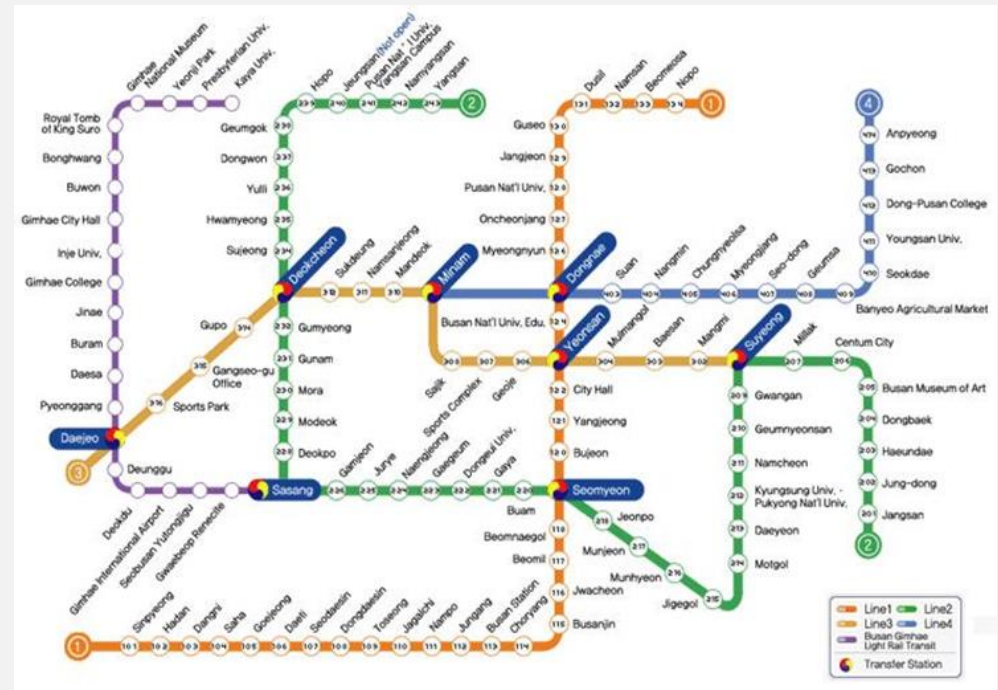

- A single ride fare (as of 1 June 2014) is 1300 won for a destination within less than 10 km (6.2 mi) and 1500 won for any other destinations. Tickets are sold at "Ticket Vending Machines". Usually most machines will accept 1000 won notes as well as coins.
- Tickets should be kept since they are required to leave the station once reaching destination, and getting caught "jumping the gate" will result in a hefty fine.

Metro pass

- **The use of a metro pass**, either Hanaro Card or a Digital Busan Card will offer a fare discount of 10% to adults and 20% to youth of 13-18 of age.
- Both the Hanaro and the Digital Busan cards, are available in either card format or a more compact, yet slightly more expensive cell phone accessory format. The passes are equipped with a microchip and are scanned by laying them against sensor plates at the entrance and exit of stations. This makes them more efficient than magnetic stripe cards since they can be detected through a wallet or purse.
- Hanaro Cards are for sale at all stations for 2000 won. All type of passes can have credit added to them in any station at the "Automatic Charge Machine" ; the instructions are available in both English and Korean. The passes can also be used to pay for bus fares and for purchases on specially equipped vending machines throughout the city.

Tourist Attractions

Leisurely walk on the Beach – Haeundae Beach



Tourist Attractions

Korean Traditional Market – Gukje Market



Tourist Attractions

Largest Fish Market in Korea - Jagalchi Fish Market



Tourist Attractions

Exciting Nightlife at Gwangalli Beach



Tourist Attractions

Breathtaking Coastal Sceneries – Tae Jong Dae



Tourist Attractions

1,300 Years of History – Beomeosa Temple



Tourist Attractions

World's Largest Department Store - Shinsegae



Tourist Attractions

The Korean version of "Machu Picchu" - GAMCHEON Culture Village

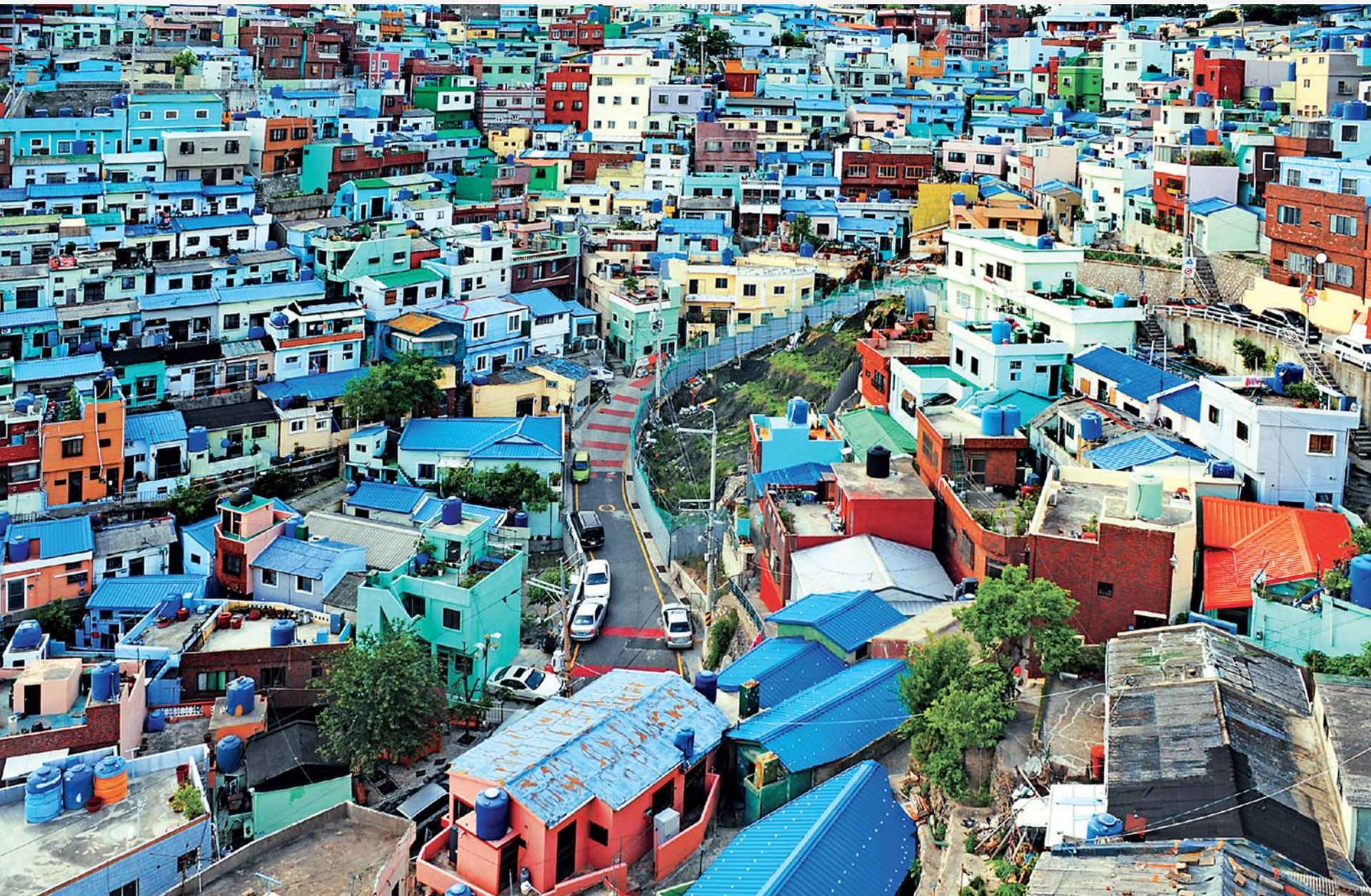

Tourist Attractions

Accompanying Persons Tour Program (full day tour)

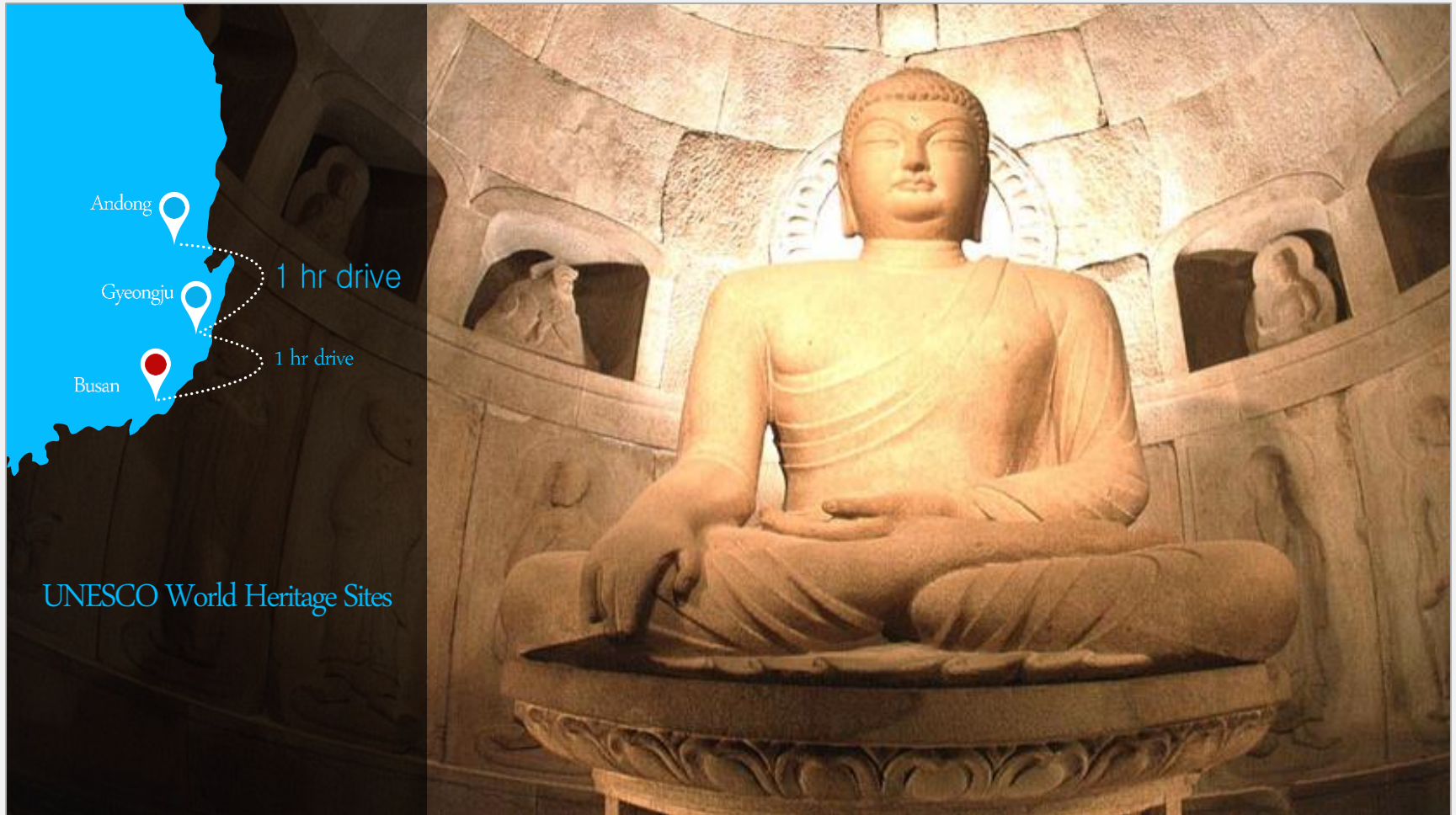

Thank you and See you in Busan!!!

